

Description

- Factory fabricated from wood fiber insulation board.
- Cut on angles that slope from zero on one edge to 1/2" to 2" on the opposite edge.
- Designed for smooth transition from lower to higher elevations.
- Easy to fabricate for installation with most types of roof systems.
- Available in bundles 48" in length.

Uses

- To provide smooth transition from lower to higher elevations around roof edges, drains or wherever slope to 0" is required.
- Properly installed, Woodfiber roof insulation is suitable for use under built-up, modified bitumen and some single ply roofing systems.
- Refer to the application specifications in the current Membrane Manufacturer's Application and Specifications Manual for proper installation procedures for Woodfiber roof insulation.

Specification Benefits

- UL Listed Class A ASTM C208, C209.
- Strong and dimensionally stable.
- Available in standard heights and widths.
- Can be shipped in mixed loads with roof insulation and tapered systems.
- Multiple shipping locations.
- Easily identifiable bundles.
- Edge strips are made from wood fiber which incorporates up to 18% post-consumer recycled content percentage and up to 78% preconsumer recycled content percentage.

Limitations

- Woodfiber roof insulation is a non-structural, non-load bearing material.
- Woodfiber roof insulation should not be left exposed to the weather.
- No more insulation should be applied than can be completely covered with finished roofing on the same day.
- It is NOT designed for use under fully adhered single ply systems nor for direct torch application of modified bitumen.
- If torch grade, modified bitumen roofing is to be installed over Woodfiber, a fiber glass base sheet MUST first be installed.

Woodfiber Tapered Edge Strip

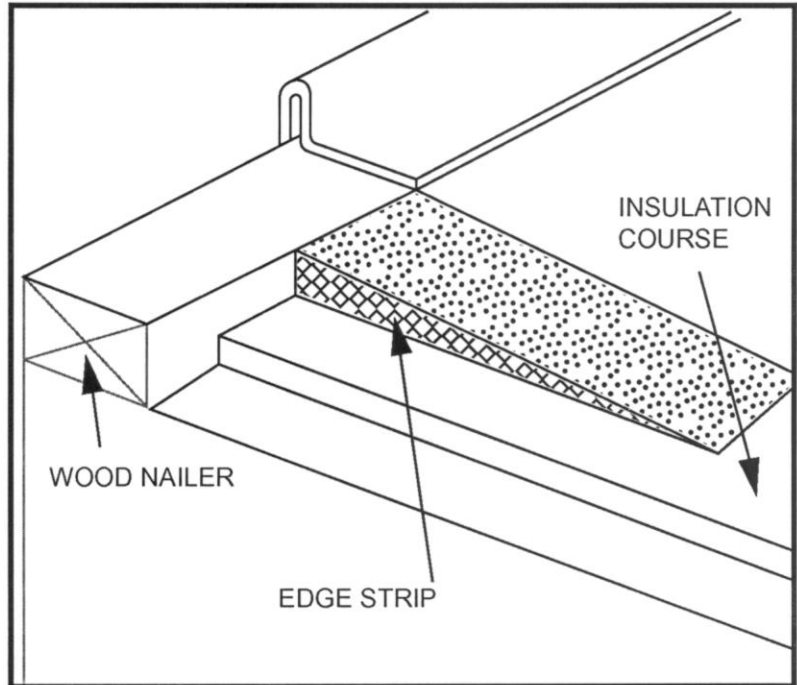

Tapered Edge Strip Sizes and Packaging

	Per Bundle		Per Pallet	
	Pieces	Ln. Ft	Bdls	Ln. Ft.
1/2" x 6" x 48	72	288	20	5760
1/2" x 12" x 48	36	144	20	2880
1" x 6" x 48	56	224	14	3136
1" x 12" x 48	28	112	14	1568
1" x 18" x 48	18	72	12	864
1" x 24" x 48	18	72	10	720
1 1/2" x 6" x 48	24	96	20	1920
1 1/2" x 12" x 48	12	48	20	960
1 1/2" x 18" x 48	12	48	10	480
1 1/2" x 24" x 48	12	48	10	480
2" x 12" x 48	8	32	24	768
2" x 18" x 48	6	24	16	384
2" x 24" x 48	6	24	16	384