

Description

- Factory fabricated from Perlite rigid perlite insulation board.
- Cut on angles that slope from zero on one edge to ½ to 2" on the opposite edge.
- Designed for smooth transition from lower to higher elevations.
- Easy to fabricate for installation with most types of roof systems.
- Available in bundles 48" in length.

Uses

- To provide smooth transition from lower to higher elevations around roof edges, drains or wherever slope to 0" is required.
- Properly installed, Perlite roof insulation is suitable for use under built-up, modified bitumen and some single ply roofing systems.
- Refer to the application specifications in the current Membrane Manufacturer's Application and Specifications Manual for proper installation procedures for Perlite roof insulation.

Specification Benefits

- UL Flame Spread Rating 25.
- Strong and dimensionally stable.
- Available in standard heights and widths.
- Can be shipped in mixed loads with roof insulation and tapered systems.
- Multiple shipping locations.
- Easily identifiable bundles.
- Edge strips have at least 25% post-consumer recycled content and comply with the Environmental Protection Agency Regulation 40 CFR Part 248, "Guideline for Federal Procurement of Building Insulation Products Containing Recovered Materials", as a recycled product approved for use on any project using federal funds.

Limitations

- Perlite roof insulation is a non-structural, non-load bearing material.
- Perlite roof insulation should not be left exposed to the weather.
- No more insulation should be applied than can be completely covered with finished roofing on the same day.
- It is NOT designed for use under fully adhered single ply systems nor for direct torch application of modified bitumen.
- If torch grade, modified bitumen roofing is to be installed over Perlite, a fiber glass base sheet MUST first be installed.

Perlite Tapered Edge Strip

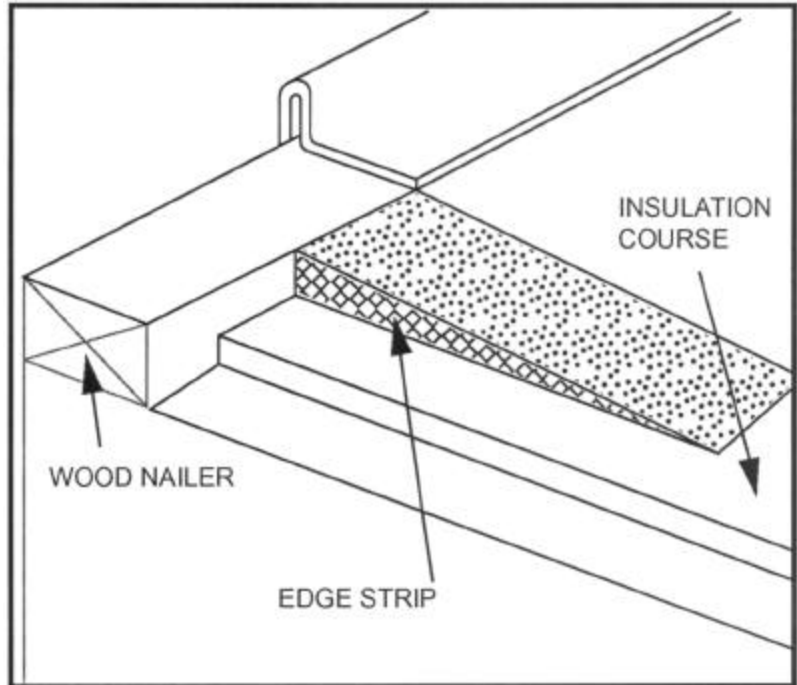

Tapered Edge Strip Sizes and Packaging

	Per Bundle		Per Pallet	
	Pieces	Ln. Ft	Bdls	Ln. Ft.
½ x 6" x 48	72	288	20	5760
½ x 12" x 48	36	144	20	2880
1" x 6" x 48	56	224	14	3136
1" x 12" x 48	28	112	14	1568
1" x 18" x 48	18	72	12	864
1" x 24" x 48	18	72	10	720
1 ½ x 6" x 48	24	96	20	1920
1 ½ x 12" x 48	12	48	20	960
1 ½ x 18" x 48	12	48	10	480
1 ½ x 24" x 48	12	48	10	480
2" x 12" x 48	8	32	24	768
2" x 18" x 48	6	24	16	384
2" x 24" x 48	6	24	16	384



This symbol identifies this Perlite® product as one that uses a substantial amount of recycled materials and is biodegradable in the future.